



## II 2 GD Ex d IIC Ex tD A21 - Sirene elettromeccaniche antideflagranti

## II 2 GD Ex d IIC Ex tD A21 - Explosion-proof electric motor sirens

V 12-24-110-240 (-10%)	==	50/60 Hz	On: 1 min. Off: 10 min.
IP 65 66		°C -50 +50	Ø 1/2" NPT Ø 3/4" ISO 7/1**

IP 66



	ISSeP 08 ATEX 004 X T6			
V	12	24	110	240
A	3	1.6	0.45	0.3
dB(A)1m	100	100	100	100
Hz	1500	1500	1600	1600

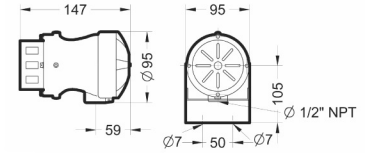

Kg. 1,45



	INERIS 02 ATEX 0001 T6			
V	12	24	110	240
A	15	8.5	2	1
dB(A)1m	109	109	109	109
Hz	1150	1250	1300	1300

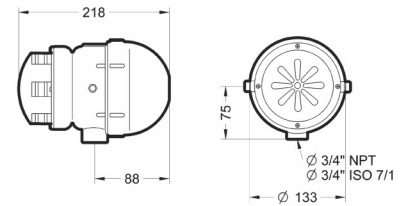

Kg. 3,20



	INERIS 02 ATEX 0001 T6			
V	12	24	110	240
A	12	6.3	2	1
dB(A)1m	114	114	114	114
Hz	650	650	650	650

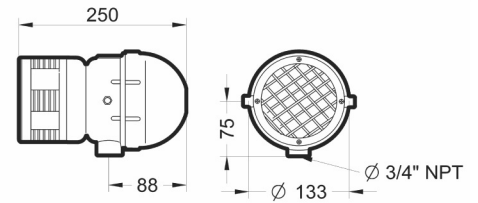

Kg. 3,45



## II 2 GD Ex d IIC Ex tD A21 - Sirene elettroniche antideflagranti

## II 2 GD Ex d IIC Ex tD A21 - Explosion-proof electronic sirens

V 12/24-110-240 (-10%)	==	50/60 Hz	On ∞	IP 65
	°C -50 +50		Ø 3/4" ISO 7/1	



	INERIS 02 ATEX 0074 T6		
V	12÷24	-	-
V		110	240
mA	865	45	30
dB(A)1m	Min. 91 - Max. 109		

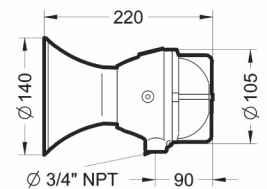

Kg. 1,40



	ISSeP 01 ATEX 014 T6	
V	12÷24	-
V		240
mA	550	25
dB(A)1m	Min. 101 - Max. 112	

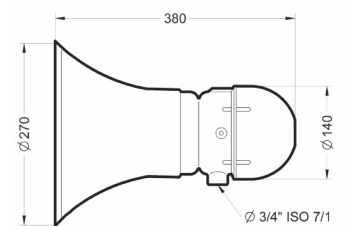

Kg. 3,35